



SHACKLES

Green Pin from Van Beest is a premium European manufactured shackle respected worldwide and has become synonymous with exceptional quality, safety and professional reliability.

Green Pin® Standard Shackles

- **Material** : Bow and pin high tensile steel, Grade 6, quenched and tempered
- **Safety Factor** : MBL equals 6 x WLL
- **Standard** : EN 13889 and meets performance requirements of US Fed. Spec. RR-C-271
DNV type approved to certification note 2.7-1
- **Finish** : Hot dipped galvanized
- **Temperature Range** : -20°C up to +200°C
- **Certification** : At no extra charges this product can be supplied with a works certificate, material certificate, manufacturer test certificate and/or EC Declaration of Conformity



G-4161



G-4151

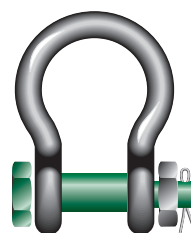
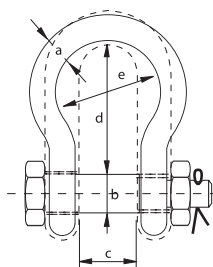

G-4163

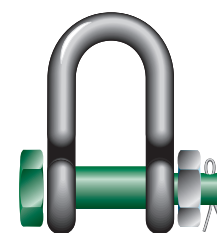

G-4153

working load limit	diameter bow	diameter pin	width inside	length inside		width bow	weight each	
				dee type	bow type		screw pin	safety bolt
tons	a mm	b mm	c mm	d mm	d mm	e mm	kg	kg
0.33	5	6	9.5	19	22	16	0.02	--
0.5	7	8	12	22	29	20	0.05	0.06
0.75	9	10	13.5	26	32	22	0.10	0.11
1	10	11	17	32	36.5	26	0.14	0.16
1.5	11	13	19	37	43	29	0.19	0.22
2	13.5	16	22	43	51	32	0.36	0.42
3.25	16	19	27	51	64	43	0.63	0.74
4.75	19	22	31	59	76	51	1.01	1.18
6.5	22	25	36	73	83	58	1.50	1.77
8.5	25	28	43	85	95	68	2.21	2.58
9.5	28	32	47	90	108	75	3.16	3.66
12	32	35	51	94	115	83	4.31	4.91
13.5	35	38	57	115	133	92	5.55	6.54
17	38	42	60	127	146	99	7.43	8.19
25	45	50	74	149	178	126	12.84	14.22
35	50	57	83	171	197	138	18.15	19.85
42.5	57	65	95	190	222	160	26.29	28.33
55	65	70	105	203	260	180	37.6	39.59
85	75	83	127	229	329	190	--	62

